

# WULFTEC® WRWA-200

## HORIZONTAL STRETCH WRAPPER

# WULFTEC RETHINKS HORIZONTAL WRAPPING

THE NEW, IMPROVED WAY TO WRAP DOORS, WINDOWS, CARPETS, TEXTILES,  
LUMBER, COPPER PIPING, MAGAZINES, CORRUGATED TUBING... AND MORE.



### ECONOMICAL

Maximize the use of stretch film. The WRWA's NO-THREAD® Powered Pre-Stretch Carriage optimizes film performance, using less film without compromising wrapping strength. Contrary to the competition, light gauge film may be used with this machine. State-of-the-art AC variable frequency drives ensure low maintenance, saving valuable time and money. Troubleshooting is easy, with quick identification by the digital panel interface.

### EASY TO OPERATE

The WRWA-200 carriage features a loading clamp and rapid-lock film roll device that make loading a snap. Everything can be done in the same area, with easy access to the carriage for simplified re-loading. Maintenance free clamping and cutting device. The user-friendly digital panel interface offers multiple mode selection for more flexibility. Just set, load and go!

### CRAFTED FOR SUCCESS

For increased productivity, this quality engineered stretch wrapper features:

- A precise heavy-duty ring bearing gearbelt drive system
- Bluetooth technology used for reduced maintenance

### THE WULFTEC PROMISE

Having a Wulftec® stretch wrapping machine on the production line is a powerful statement. It's an investment in strong values, because Wulftec is dedicated to manufacturing only the best. It's an investment in all-steel construction, for increased stability and strength. It's an investment in success, because Wulftec® equipment is designed and built to work hard.

**PRODUCTIVITY AT SPEEDS  
UP TO 60 RPM\***



**WE FEAR NO PACKAGING CHALLENGE**  
**WWW.WULFTEC.COM**



# WE FEAR NO PACKAGING CHALLENGE

WWW.WULFTEC.COM

## TECHNICAL SPECIFICATIONS

PRODUCTION RATE*	- Up to 120 loads per hour
LOAD SIZE	- Maximum diagonal load dimension must be 8" (4" on each side) shorter than ring size
LOAD WEIGHT	- Up to 5,000 lbs
MACHINE DIMENSIONS	- See diagram
APPROXIMATE SHIPPING WEIGHT	- 3,000 lbs to 6,000 lbs depending on model & options
ELECTRICAL REQUIREMENTS	- 230V/3/60 20A
PNEUMATIC REQUIREMENTS	- Up to 6 CFM @ 80 PSI comes with FR (Filter, Regulator)
FILM DELIVERY SYSTEM	- 20" NO-THREAD® powered pre-stretch carriage with revolutionary spring loaded carriage gate - Rapid-lock film roll device
AVAILABLE RING SIZES	- 36, 60, 90 inch diameter
OPTIONS	- Top hold down - Side guides - Transformer - Heat seal - Bridge conveyors - Dual bridge conveyor - Conveyors (belt, chain, rollers, gravity)
STRUCTURE	- Heavy-duty structural steel construction - Ergonomically friendly film loading carriage position
WARRANTY	- 3-year unlimited cycle warranty - 3-year warranty on ring bearing - 10-year warranty on steel structure - Lifetime warranty on pre-stretch rollers' blue compound

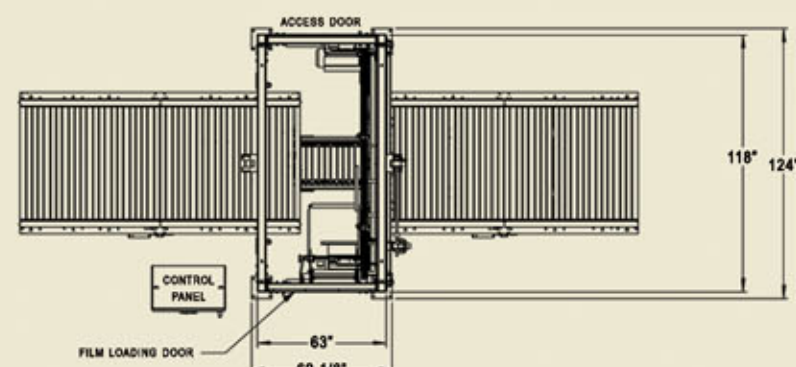
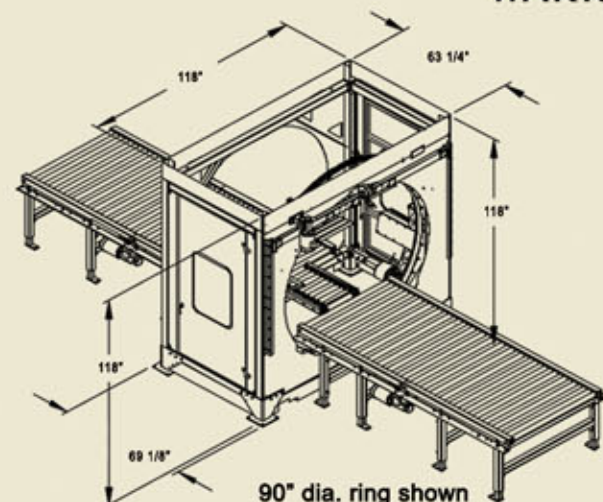

**Reduced energy usage by throughput anticipation on automatic machines:** Machine will operate at a lower speed when the throughput from the line is slower and speedup to allow production bursts. *For an average production line† the energy savings would equal 20 x 40W lamps lit for 6 hours.*

**Reduced film waste by optimized resolution:** Machine will use a higher resolution positioning system to deliver the film in a more accurate quantity - this means an average film reduction of 4 feet of film per pallet when compared to other control systems. *That's 60 miles† of unstretched film per year.*

**Reduced general waste by better product protection for handling and transport:** The product is properly secured to the pallet, resulting in a pallet that is more stable for transport, and therefore less damage.

**By using VFD on all motors,** this ensures that only the power required by the load is used, regardless of the HP of the motor.

\* PRODUCTION RATE BASED ON LOAD AND MACHINE SIZE AND CONFIGURATION

† BASED ON A PRODUCTION RATE OF 60 PALLETS PER HOUR, 2 SHIFTS, WHERE 50% OF THE PRODUCTION IS IN "PEAK-MODE", 250% PRE-STRETCH

ALL MACHINE SPECIFICATIONS ARE SUBJECT TO CHANGE WITHOUT PRIOR NOTICE / NOMINAL DIMENSIONS SHOWN / WRWA-200 SHOWN WITH OPTIONAL CONVEYORS

M.J. MAILLIS

WULFTEC.com

THE WULFTEC ENGINEERING TEAM HAS REDEFINED THE BOUNDARIES OF HORIZONTAL WRAPPERS



NO-THREAD® Powered Pre-stretch carriage



Ring bearing gearbelt drive with automatic lube station

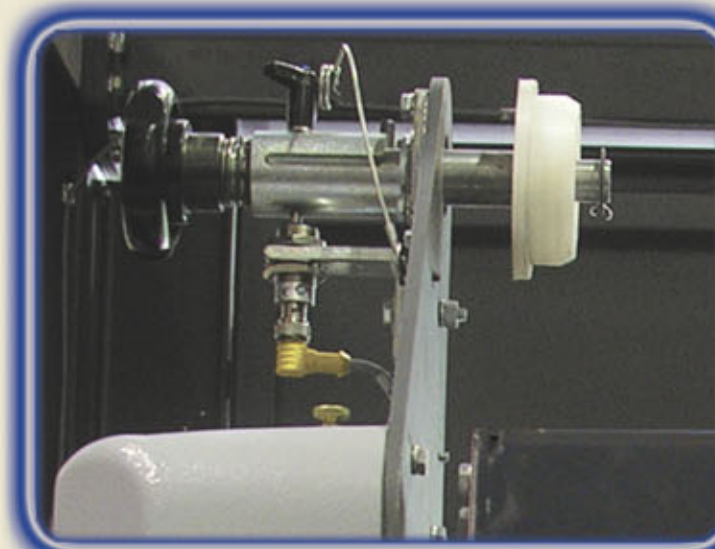

Rapid-lock film roll device

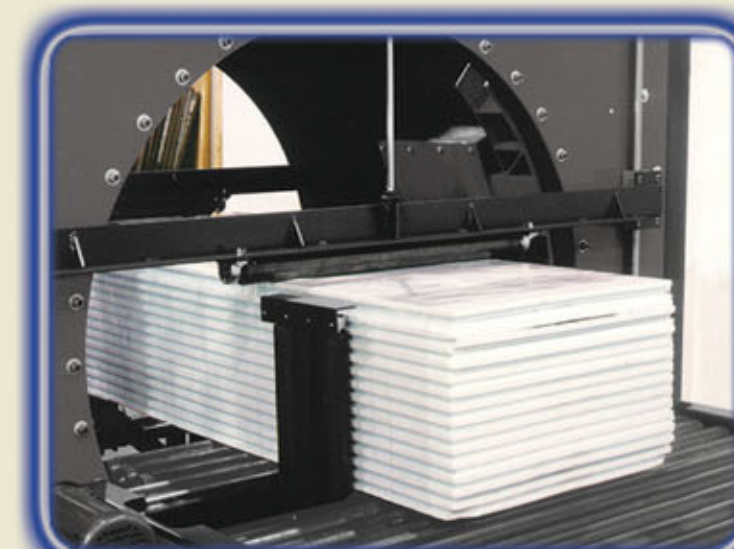

Optional side guides and hold down

